

Model: FY015

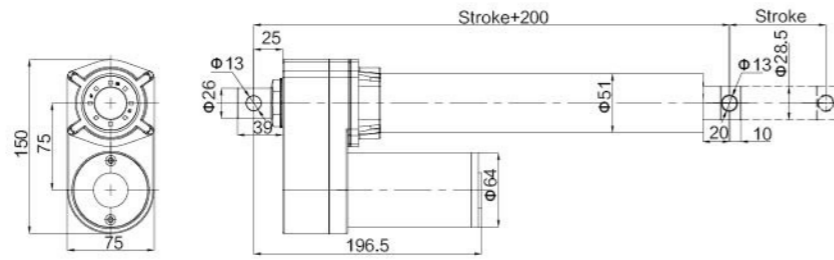

安装尺寸 | Installation Dimension



内置电位计 (可选)
Built in potentiometer (Optional)

安装尺寸 | Installation Dimension

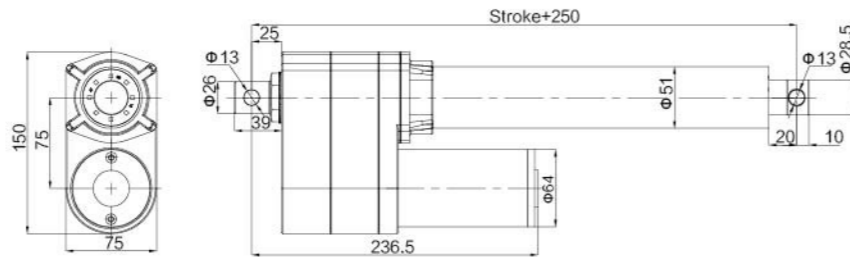

负载与电流工作图 | Load VS Current

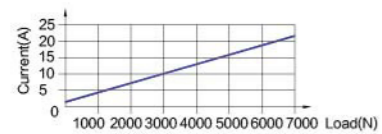

负载与速度工作图 | Load VS Speed

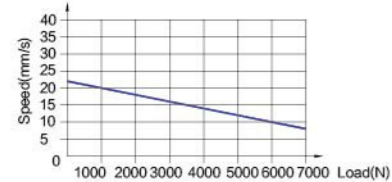

技术参数 | Specifications

输入电压 Input Voltage	48V / 36V / 24V / 12V DC
最大负载 Load Capacity	7000N
最大速度 Max Speed	5mm/s (7000N), 67mm/s (750N)
行程 Stroke	50 ~ 1000mm (可选 Optional)
使用频率 Type of Duty	10%, 2min. on / 18min. off
行程开关 Limit Switches	内置 Inner
环境温度 Operation Temperature	-15°C ~ 65°C
防护等级 Protection Class	IP65

Model: FY017



安装尺寸 | Installation Dimension

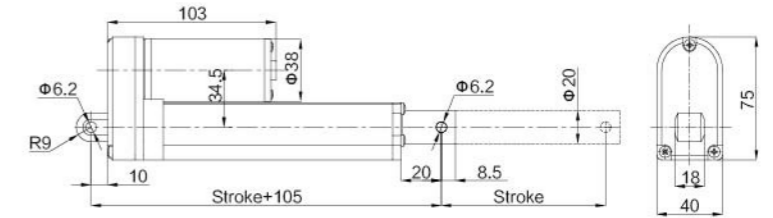

内置电位计或霍尔
Built in potentiometer or hall

安装尺寸 | Installation Dimension

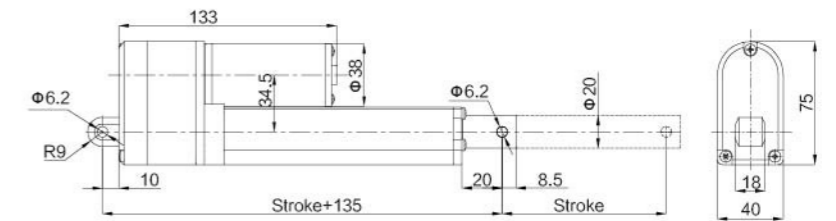

负载与电流工作图 | Load VS Current

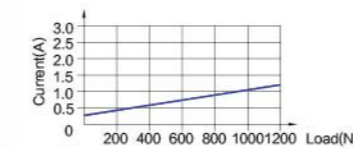

负载与速度工作图 | Load VS Speed

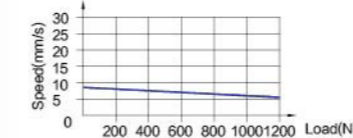

技术参数 | Specifications

输入电压 Input Voltage	48V / 36V / 24V / 12V DC
最大负载 Load Capacity	1200N
空载速度 Speed	5 ~ 40mm/s
行程 Stroke	0 ~ 600mm (可选 Optional)
使用频率 Type of Duty	10%, 2min. on / 18min. off
行程开关 Limit switches	内置 Inner
环境温度 Operation Temperature	-15°C ~ 45°C
防护等级 Protection Class	IP65